

SpinTORQ

HYDRAULIC TORQUE WRENCH

Operation & Maintenance Guide

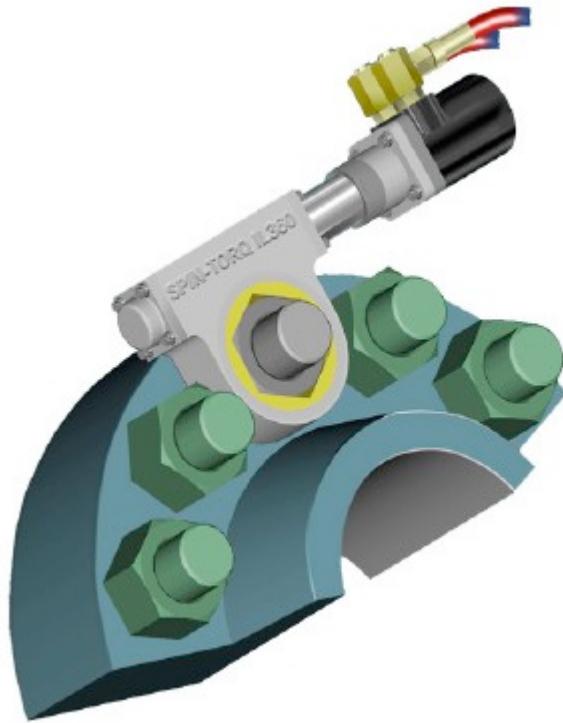

KEEP FOR YOUR RECORDS

INTRODUCTION

The SpinTORQ is a 360 degree, continuously rotating hydraulic torque wrench.

It is powered by using external hydraulics such as the tong circuit on a drilling rig or the FASTORQ® Model 603A SpinTORQ Power Unit.

Unit Specifications

Air Input Required	90 PSI
Air Input Hose	1" Dia.
Hydraulic Input Flow	
Maximum	20 GPM
Minimum	3 GPM
Hydraulic Output Pressure	
Maximum	3000 PSI

OPERATING INSTRUCTIONS

1. Each SpinTORQ hex cartridge (Fig 1) is a sealed unit. The precision gearing is installed and adjusted at the factory.

DO NOT LOOSEN OR REMOVE THE END CAPS (A and B) OR THE RETAINING RING (C).

Opening these connections will void the warranty.

2. Check the gear grease level before each use. Open the gear grease port. If grease is required, use only SpinTORQ Gear Grease as supplied with the unit.
3. The SpinTORQ hex cartridges are connected to the hydraulic motor at the splined connection (E). Several cartridges of different sizes may be interchangeably connected to the motor.
4. To operate the SpinTORQ, refer to the "Pressure vs. Torque Chart" supplied with each serial numbered unit.

DO NOT EXCEED THE MAXIMUM PRESSURE INDICATED ON THE TORQUE CHART.

5. Preset the SpinTORQ Control Unit or 603A Power Unit to the desired torque, and follow the instructions of the control unit.
6. Place the SpinTORQ on the nut and press one of the buttons on the control pendant to start rotation. To reverse direction of rotation, press the other button.
7. During the torquing operation, allow the SpinTORQ cartridge end cap "A" to react against an adjacent nut. This is the preferred reaction point. When loosening, turn the SpinTORQ over so end cap "A" is the reaction point.
8. When the nut is torqued to preset level, the SpinTORQ cartridge will stall.
9. To release the reaction point, reverse the SpinTORQ rotation a few degrees until loosened.



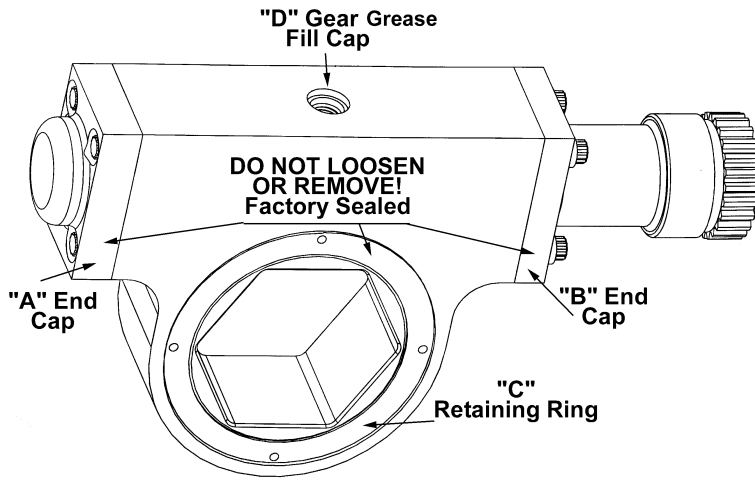

Figure 1

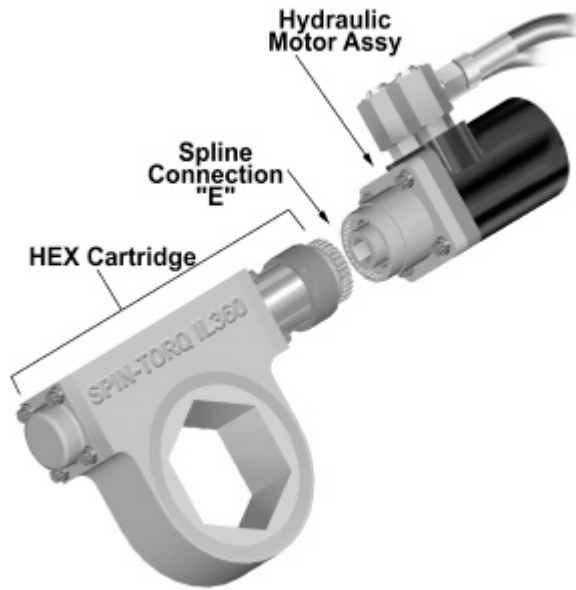

Figure 2

SpinTORQ

DIMENSIONS

MODEL	HEX SIZES Inches (MM)	TORQUE RANGE Ft-Lb (N-M)	DIMENSIONS (Refer to Figure 3)								WEIGHT Lbs. (Kilograms)
			A Inches (MM)	B Inches (MM)	C Inches (MM)	D Inches (MM)	E Inches (MM)	F Inches (MM)	G Inches (MM)	H Inches (MM)	
IL360-113	1-13/16 (46)	200-700 (270-950)	15.50 (393.7)	9.75 (247.65)	3.625 (92.08)	3.281 (83.34)	1.312 (33.32)	3.875 (98.43)	1.400 (35.56)	1-13/16 (46)	5.00 (2.3)
IL360-200	2 (50)	200-900 (270-1220)	15.50 (393.7)	10.250 (260.35)	3.625 (92.08)	3.281 (83.34)	1.500 (38.1)	5.000 (127)	1.875 (47.63)	2 (50)	6.50 (2.9)
IL360-203	2-3/16 (55)	300-1200 (400-1630)	16.000 (406.4)	10.250 (260.35)	3.625 (92.08)	3.281 (83.34)	1.500 (38.1)	5.000 (127)	1.875 (47.63)	2-3/16 (55)	6.50 (2.9)
IL360-206	2-3/8 (60)	400-1600 (540-2170)	17.625 (447.68)	11.750 (298.45)	3.625 (92.08)	3.281 (83.34)	1.875 (47.63)	5.625 (142.88)	2.000 (50.8)	2-3/8 (60)	12.00 (5.4)
IL360-209	2-9/16 (65)	600-2200 (800-3000)	18.500 (469.90)	12.750 (323.85)	3.625 (92.08)	3.281 (83.34)	2.000 (50.8)	6.125 (155.58)	2.250 (57.15)	2-9/16 (65)	15.50 (7.0)
IL360-212	2-3/4 (70)	800-2800 (1100-3800)	18.500 (469.90)	12.750 (323.85)	3.625 (92.08)	3.281 (83.34)	2.000 (50.8)	6.125 (155.58)	2.250 (57.15)	2-3/4 (70)	14.50 (6.6)
IL360-215	2-15/16 (75)	1000-3400 (1350-4600)	19.0 (482.6)	13.25 (336.55)	3.750 (95.25)	3.281 (83.34)	2.250 (57.15)	6.520 (165.61)	2.285 (58.04)	2-15/16 (75)	18.0 (8.18)
IL360-302	3-1/8 (80)	1200-4000 (1630-5420)	19.0 (482.6)	13.25 (336.55)	3.750 (95.25)	3.281 (83.34)	2.400 (60.96)	7.250 (184.15)	2.750 (69.85)	3-1/8 (80)	23.0 (10.45)
IL360-308	3-1/2 (89)	1400-5000 (1900-6780)	21.500 (546.1)	14.000 (355.6)	4.000 (101.6)	3.281 (83.34)	2.500 (63.5)	8.000 (203.2)	3.000 (76.2)	3-1/2 (90)	28.00 (12.7)
IL360-314	3-7/8 (98)	2100-7000 (2850-9500)	21.500 (546.1)	14.000 (355.6)	4.000 (101.6)	3.281 (83.34)	2.500 (63.5)	8.000 (203.2)	3.000 (76.2)	3-7/8 (98)	28.00 (12.7)

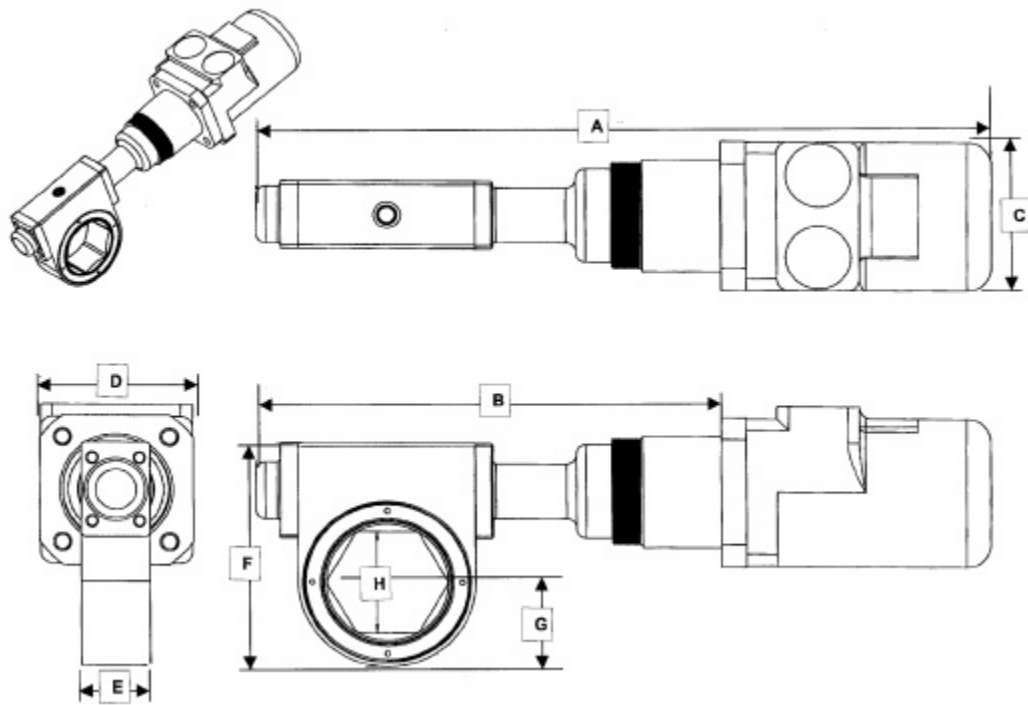

Figure 3



FASTORQ

18914 East Industrial Parkway, New Caney, TX 77357

Global 281.449.6466 • US & Canada 800.231.1075 • Fax 281.572.1329

Email: sales@fastorq.com • Website: www.fastorq.com